



BUILDING SPECIFICATIONS

SANTONIO
BY les RIVAGES®



- 1.** Foundation
- 2.** Structure
- 3.** Roof
- 4.** Masonry
- 5.** Coating
- 6.** False ceiling
- 7.** Flooring and cladding
- 8.** Plumbing
- 9.** Electricity and telecommunications
- 10.** Exterior carpentry
- 11.** Wood carpentry
- 12.** Bathroom fittings
- 13.** Lift
- 14.** Heating system and air conditioning
- 15.** Security
- 16.** Laundry area
- 17.** Mini swimming pool/jacuzzi
- 18.** Kitchen
- 19.** Bioclimatic pergola and glass curtain

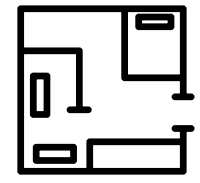

1. FOUNDATION

Solid reinforced concrete slab.

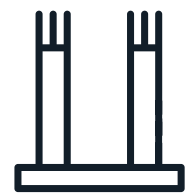

2. STRUCTURE

Reinforced concrete structure, with concrete pillars and bidirectional slabs and decorative concrete cornice.

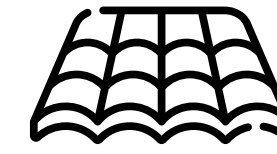

3. ROOF

- Inclined cover with ceramic curved tiles, aged finish.
- Traditional flat roof in Andalusian style with thermal insulation based on extruded polystyrene of 40 and 60 mm thickness.
- Layer of impact sound insulation on terraces.
- Waterproof roofs via asphalt sheet.



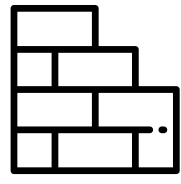

4. MASONRY

- Enclosure made with perforated brick factory of 10 cm. Thickness, mortar of cement mortar, thermal insulation, and acoustic insulation to aerial noise air chamber and partition wall 5 cm thick.
- Dry partition in the interior, consisting of PYL self-supporting partitions with a double 13 mm plate. And acoustic insulation to airborne noise.



5. COATING

- Wall coating with perlite mortar and plaster of medium thickness of 15 mm.
- Smooth plastic paint on vertical and horizontal walls throughout the house.
- Exterior coating with single layer mortar with fine scraped finish.



6. FALSE CEILING

- Laminated plaster board on ceiling.
- False ceiling made of water-proof plasterboard in bathrooms.
- Curtain rods in all bedrooms.
- Living room and kitchen ceiling with plater coat of 1,5 cm thickness.

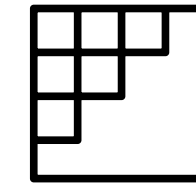

7. FLOORING AND CLADDING

- Floors with high strength ceramic tiles dimensions 75 x 75 cm. And DM skirting white lacquered of 14 cm height.
- Outdoor flooring same material with anti-slip treatment. With a perimetral bed with decorative white gravel and central area with artificial grass.
- The shower wall area with Ceramic decorated tiles 1,20 x 2,60 m and 6 mm thickness. Part of the walls painted and installation of wall paper according to interior design project.
- Jacuzzi area will be coated with wooden flooring technology DECK.

METROPOL

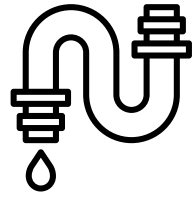

8. PLUMBING

- Indoor plumbing installation with multilayer pipe including heat-insulated. Hot water recirculation system.
- Production of domestic hot water through electric boiler.
- Downspouts and sanitary PVC soundproof drains, including elbows and derivations.

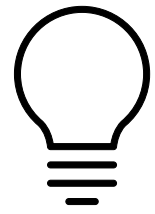

9. ELECTRICITY AND TELECOMMUNICATIONS

- Electric switches brand Jung model LS990 white Apine.
- House lightning with recessed spotlights in false ceiling LED signage strips and outdoor wall fitting.
- TV sockets in the living room, bedrooms and terraces.
- Video entry phone main floor.
- Pre installation amplification Wi-Fi network.
- Pre instalación amplificación red Wi-Fi.
- Pre installation Community satellite.
- Pre installation stores and blackouts motorization.

JUNG
DELTA LIGHT

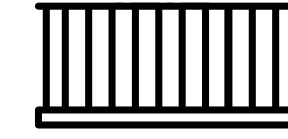

10. EXTERIOR CARPENTRY

- Tilt swings aluminium carpentry CORTIZO Brand, CORVISION serial, with low emissivity White lacquered.
- Laminar safety glass handrails on terraces.

CORTIZO

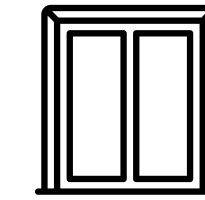

11. WOOD CARPENTRY

- Armoured aluminium entrance door.
- Polywood step door White with hidden hinges.
- Smooth pantographed wardrobe front with smooth hinged doors made of water-repellent MDF.
- Wardrobe interior according to project with lighting LED and opening sensor.
- Safe in master bedroom.

12. BATHROOM FITTINGS

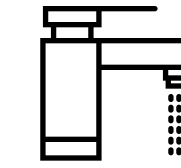
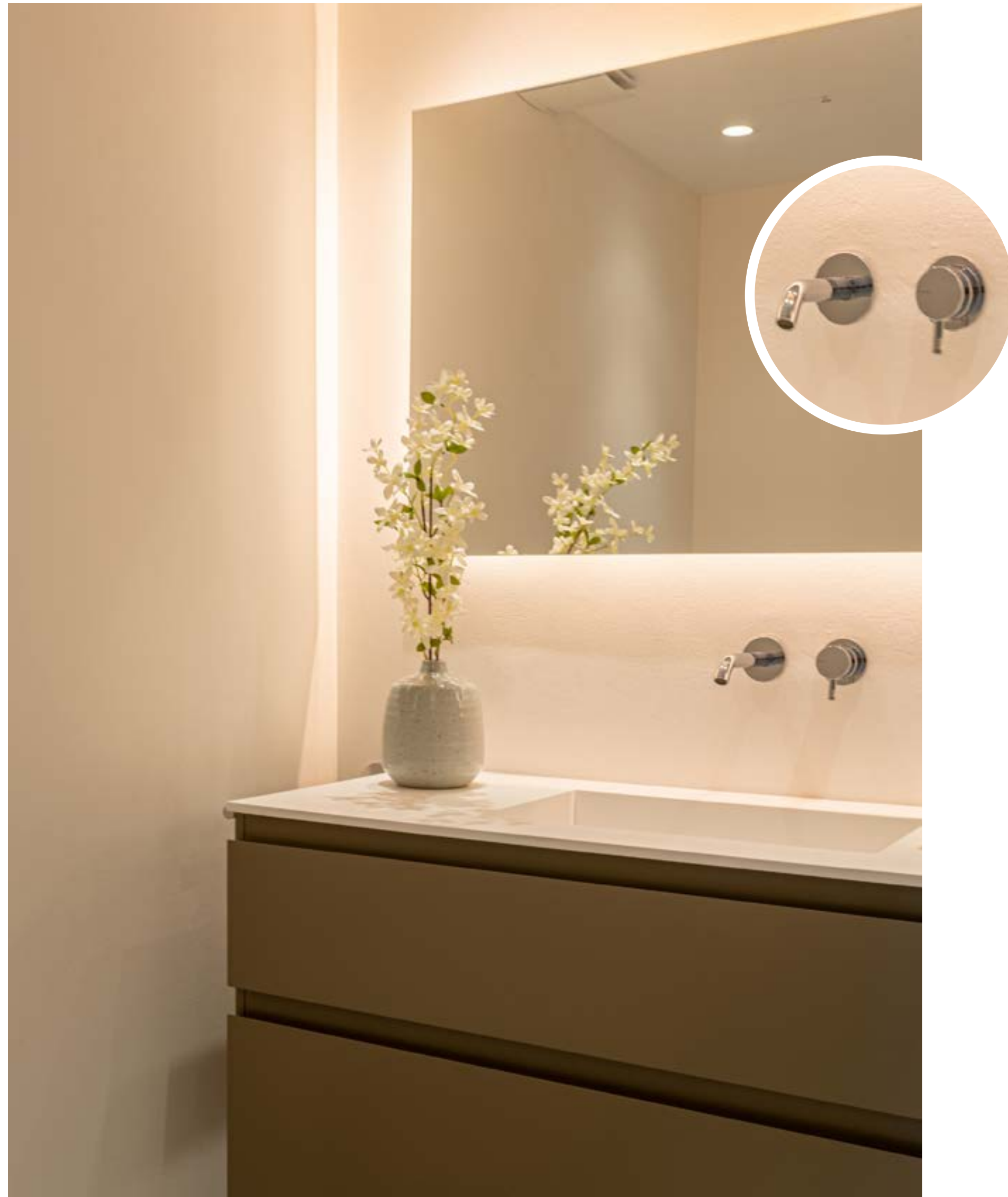

- Suspended porcelain toilet with hidden tank. Slim toilet lid with cushioned fall and push button with double discharge option, chrome finish. Higienic showers for toilet, chrome finish.
- Wall-mounted washbasin mixer taps with chrome finish. Flush-mounted mixer tap with chrome finish in showers and ceiling sprayer.
- Suspended washing basin cabinet with Solid Surface countertop with toasted oak finish countertop and washbasin support bowl 40 x 40 cm. And taps on countertop high spout.
- Retro illuminated mirror and anti-fog mesh.
- Shower trays made of the same non-slip porcelain material and linear drainage channel.
- Bathroom accessories included, roll holder, toilet brush holder, towel rack and bathroom towel hanger.



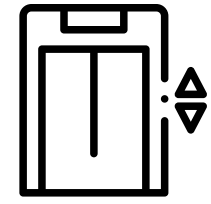

13. LIFT

Optional: Pre installation or installation for private elevator with three stops with front loading of first commercial firm.

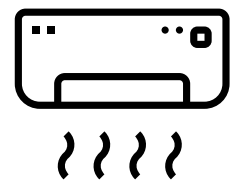

14. HEATING SYSTEM AND AIR CONDITIONING

Air conditioning by heat pump, cold and hot with individual thermostats.



15. SECURITY

Individual alarm system connected to alarm centre.

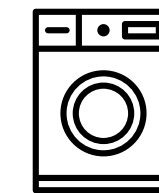

16. LAUNDRY AREA

- Silestone countertop White Zeus extreme of 2 cm.
- Teka BE 4040 sink.
- Teka Kitchen faucet with high swivel spout.
- Washing machine and Drying machine Balay 3tw976Ba.



17. MINI SWIMMING POOL/JACUZZI

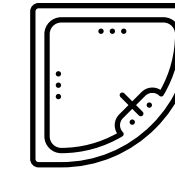

Optional: Installation of Villeroy & Boch mini swimming pool capacity 3-4 people model X-Series X4-YOU.



18. KITCHEN

SIEMENS



Kitchen installation according to design, furniture in melamin with matt lacquer finish, top quality fittings, GOLA L handles decorative sides, decorative lighting, countertop and countertop front high performance material LaminaM Calacatta gold with semi-invisible joint.

Siemens appliance equipment consisting of:

- Combi Siemens KI86SAF30 177x56 A++ integrable.
- Oven Siemens HB578G0S00 multf. 71 l. pyrolytic.
- Microwave Siemens BE555LMS0, 25 Lit. integrable.
- Induction Siemens EH651FDC1E, 3 areas, biveled.
- Extractor Siemens LB89585M, 86 cm. 800 m3/h.
- Dish washer Siemens SN615X04DE.
- Sink tectonite Franke SIRIUS SID11050 White.
- Tap Franke Fox Semipro.



19. BIOCLIMATIC PERGOLA AND GLASS CURTAIN

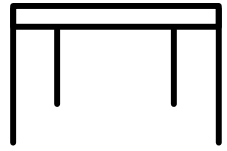

White aluminium pergola installed.



Dimensions: 6,00 x 2,60 m.

Optional: White aluminium bioclimatic with adjustable motorized blade, operated by remote control. LED lighting system incorporated and operated from the same remote control. Dimensions 6,00 x 2,60 m.

Optional: 10 mm thick glass curtain, in front of pergola with front opening.

SANANTONIO.LESRIVAGES.ES

urb. **SANANTONIO** en **La Herradura** · Granada

info.sanantonio@lesrivages.es

+34 659 610 286 / +34 958 305 764